

Hendricks Yachting Approved Yacht Sales

Offering PRINCESS - 2025 - NEW



Hendricks Yacht Club

Visit us at: Moleneind 23A 1241NG Kortenhoef

Email: hs@hsbv.nl Phone: +31183642828 Website: www.hendricksyachtclub.nl



HENDRICKS®
YACHT CLUB



Hendricks Yacht Club

Visit us at: Moleneind 23A 1241NG Kortenhoef

Email: hs@hsbv.nl Phone: +31183642828 Website: www.hendricksyachtclub.nl

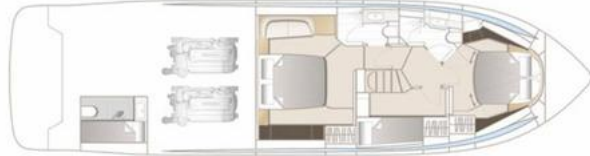

PRINCESS V 55

- Built: 2025
- Colour: White
- Dimensions: 17.80 x 4.65 x 1.45m 59 ft
- Engines: 2 x Volvo D 13 / 2 x 745 KW
- Cushions: Light grey
- Location: Uk factory
- Registered:
- VAT: excluding offered
- Extra info: Very nice spec. more info on request
- Priced at: € 2.240.000,- ex vat

The V55 is offered directly by broker Bart de Ven.

Extra info on following page.

Hendricks Yacht Club

Visit us at: Moleneind 23A 1241NG Kortenhoef

Email: hs@hsbv.nl Phone: +31183642828 Website: www.hendricksyachtclub.nl

Additional Information

The striking V55 features a sleek and dynamic exterior profile coupled with an intelligent use of space and all the exceptional performance qualities synonymous with our V Class range. Featuring premium hand-crafted materials of the highest quality, the V55 is stylish without compromising practicality or usability. Fitted with a Seakeeper 9 gyro-stabiliser she offers a smooth and comfortable ride while cruising and stability at anchor too. Many, many options like tropical AC, joystick control and aftstation, upgraded generator, watermaker etc, etc. Contact us for all the details.

Accommodations

The interior accommodates up to 6 guests in three beautifully appointed cabins, including a master suite, a VIP cabin, and a twin guest cabin, each designed with premium materials and the highest attention to detail.

The open-plan saloon is bright and airy, offering panoramic views. The electric sliding roof opens up a large section of the saloon and in combination with the sliding doors and opening aftwindow the sensation is of an open dayboat when the weather conditions allow for it. The optional teak floor in the saloon allows for a seamless flow between indoor and outdoor living spaces. Interior woodwork is in Silver Oak. Combined with Element Symphony Paris carpetry the styling is very stylish and contemporary. Carrara white galley countertop. Bathroom vanity tops are Solid Surface White (satin finish) with thermo-formed basins and Koko White floors.

Engines

2 x Volvo D13-1000 (2 x 1000HP).

Volvo joystick control with low speed manoeuvring in 'docking mode' and steering at any speed in 'driving mode'.

Operates engines, steering and thrusters. HOLD FUNCTION DOCKING FACILITY, includes fitting a 170 kgf variable speed sternthruster

Second station controls in cockpit including thruster controls and emergency engine stop

Exterior

Up/down electro hydraulic transom platform with 450Kg SWL capacity.

Teak laid side decks, foredeck and coachroof walkthrough.

Electric stern rope handling winches (2).

Electric drop window to portside saloon.

Electro-hydraulic telescopic passerelle (3.5m) with automatic hand rails Passerelle wiring - in order to be able to use the remotecontrol when the main battery master switches are off, the passerelle is wired directly to the domestic batteries via an isolation switch on the main AC/DC panel.

Electrically operated sun awning to aft end of cockpit in grey.

Stainless steel Epsilon anchor in place of standard (32Kg).

Additional 20m of 9.5 mm anchor chain to give a total of 60 metres.

Aft deck wash located in starboard transom locker.

Aft shore water inlet located in starboard transom locker.

Teak coffee table (with deck mounted fixing point) for foredeck.

Electrical systems

Continental 220v/240v sockets
AGM 90Ah batteries in place of standard (for start, domestic and generator batteries)
Fully integrated dishwasher fitted in galley
Icemaker fitted in wetbar
Underwater transom lights (4 LUMISHORE SMX53 Blue/White)
Underwater transom lights to aft hull sides (4 LUMISHORE SMX53 Blue/White)(2 per side)
Fit heated towel rail in bathrooms
Combination washer/dryer
Stern docking lights

Navigation

Standard navigation equipment incorporates:Volvo/Garmin 16" multifunction display incorporating Volvo software to allow engine instrumentation and autopilot function displays as well as a 10" display (with chartplotter/GPS with external aerial)
Garmin 434 XHD3 Radar with 48" open array (with display on standard 16" screen)
Second 16" colour multifunction display fitted at helm position
Garmin AIS Class B transponder interfaced with chartplotters
Garmin 315 VHF/DSC with intercom (International)
Plotter: EU version

Audio and video

Deck Saloon - 50" LED TV (on a powered lift) with Fusion Apollo MS-RA770 with AM/FM/Bluetooth/DAB/WIFI and external USB. Paired with Focal speakers (2)Master stateroom – 43" LED TV with Fusion Apollo MS-RA670 with DAB/Wi-Fi and external USB. Paired with Focal speakers (2)Cockpit – Fusion speakers (2) linked to Deck saloon audio system with local control (Fusion Apollo ERX-400)Includes 2 x Fusion ARX-70 wireless remotes in black (supplied loose for later fitting)
Deck Saloon TV lift with 180° swivel allowing cockpit/saloon viewing